



T9090U-UNL1 Series High Power UV LED

Introduction

The T9090U-UNL1 product is a compact, high quality and reliable 12-chip UV LED. Featuring high radiometric power density and design flexibility - the T9090U-UNL1 spectrum can be tailored to your printer, inkjet, glue adhesive curing, and other general purpose UV applications.

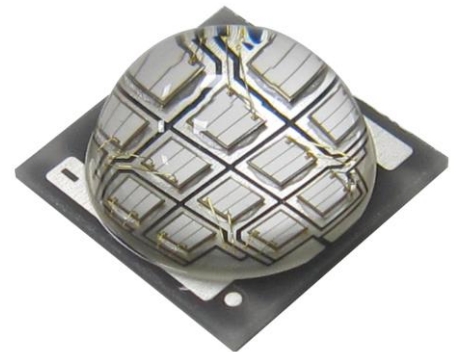

Table of Contents

Characteristics	1
Mechanical Dimensions	3
Recommended Solder Pad Design.....	4
Relative Spectral Power Distribution.....	5
Typical Spatial Radiation Pattern	5
Typical Forward L-I Characteristics	6
Typical Forward I-V Characteristics	6
Recommended Soldering Profile	7
Thermal Design.....	8
Packing information	9

RoHS Compliant

Characteristics

Absolute Maximum Ratings ($T_J = 25^\circ\text{C}$)

Parameter	Rating
	UV Series
DC Forward Current (mA) *	700 mA
LED Junction Temperature	150°C
LED Operating Temperature	-40°C ~ 85°C
Storage Temperature	-40°C ~ 125°C
Soldering Temperature	Max. 260°C / Max. 10sec. (JEDEC 020)
ESD Sensitivity	2,000 V HBM (JEDEC-22A-114-B)
Reverse Voltage	Not designed to be driven in reverse bias ($V_R \leq 5V$)
Preconditioning	Acc. to JEDEC Level 2

* Ambient temperature is well-controlled under 85°C

General Characteristics at 350mA

Part number	Color	Peak Wavelength λ_p		$2\theta_{1/2}$	Temperature Coefficient of V_f (mV/°C)	Thermal Resistance Junction to Pad
		Min	Max		$\Delta V_f / \Delta T_J$	(°C/W) RO_{J-L}
T9090U-UNL1	U40	380	390	140	-12.4	1.9
	U50	390	400	140	-12.4	1.9
	U60	400	410	140	-12.4	1.9
	U70	410	420	140	-12.4	1.9

Notes:

- The peak wavelength is measured with an accuracy of $\pm 1\text{nm}$
- All values stated are subject to the limits and set up of TSLC's testers. All other measurement data are defined as long-term production mean values and are only given for reference.
- A critical component is a component used in a life-support device or system whose failure can reasonably be expected to cause the failure of that life-support device or system, or to affect its safety or effectiveness of that device or system. Life support devices or systems are intended (i) to be implanted in the human body, or (ii) to support and/or maintain and sustain human life. If they fail, it is reasonable to assume that the health of the user may be endangered. Components used as a critical component must be approved in writing by TSLC Corporation.
- These devices emit high intensity UV/NUV light. Necessary precautions must be taken during operation. Do not look directly into the light or look through the optical system when in operation. Protective eyewear should be worn at all times during operation.
- Do not drive at rated current for more than 1 second without proper thermal management.
- Always follow thermal design recommendations in the relevant Application Note.

Radiometric Power and Forward Voltage ($T_j = 25^\circ\text{C}$)

Part number	Color	Performance at Test Current (350mA)				Performance at 700mA
		Group	Minimum Radiometric Power (W)	VF		*Calculated Minimum Radiation Power (W)
				Min	Max	
T9090U-UNL1	U40	NK4	5.5	33.6	44.4	9.9
		NK5	6.0	33.6	44.4	10.8
		NK6	6.5	33.6	44.4	11.7
	U50	NK4	5.5	33.6	44.4	9.9
		NK5	6.0	33.6	44.4	10.8
		NK6	6.5	33.6	44.4	11.7
	U60	NK4	5.5	33.6	44.4	9.9
		NK5	6.0	33.6	44.4	10.8
		NK6	6.5	33.6	44.4	11.7
	U70	NK4	5.5	33.6	44.4	9.9
		NK5	6.0	33.6	44.4	10.8
		NK6	6.5	33.6	44.4	11.7

- Note: 1. Radiometric power is measured with an accuracy of $\pm 10\%$
 2. The forward voltage is measured with an accuracy of $\pm 0.2\text{V}$
 * Calculated values are for reference only.

Mechanical Dimensions

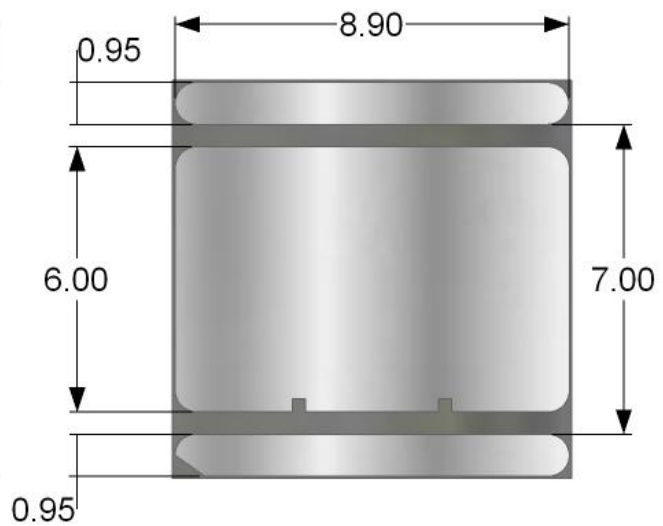
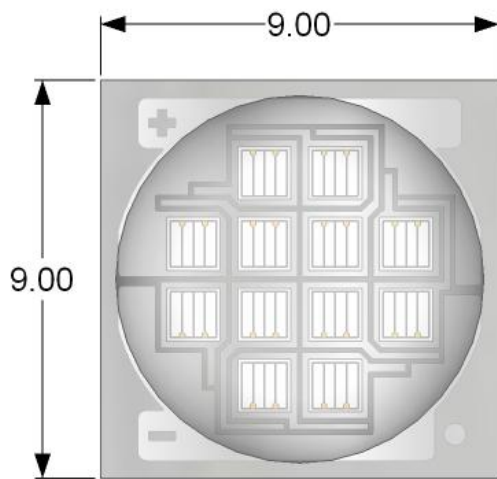
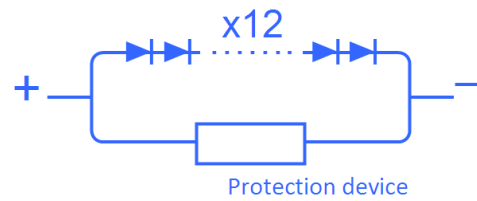
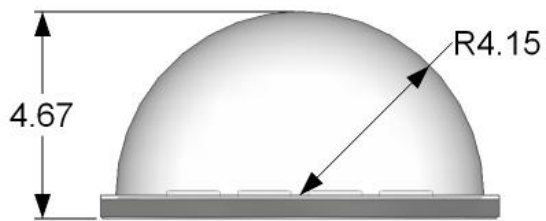
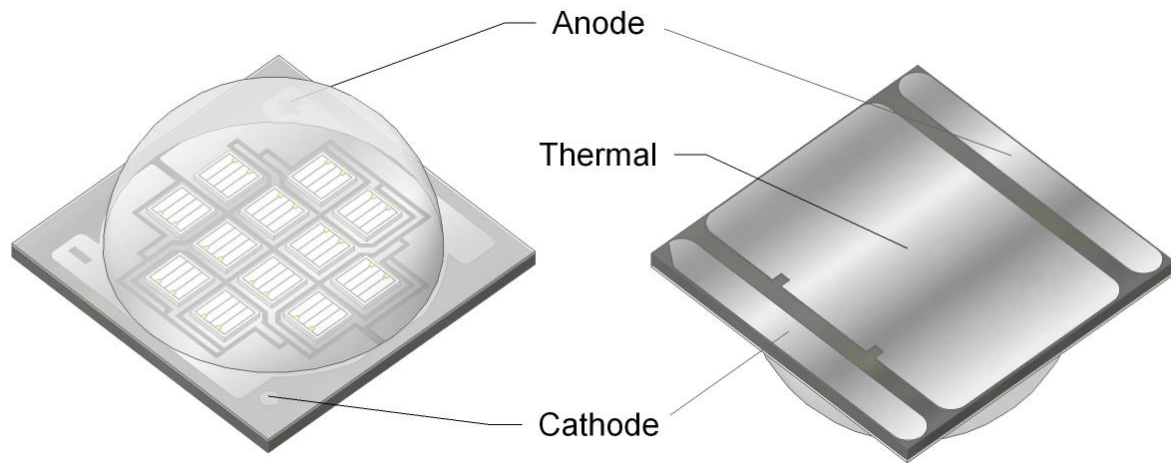

Notes :

1. Drawing is not to scale
2. All dimensions are in millimeter
3. Dimensions are $\pm 0.13\text{mm}$ unless otherwise indicated

Recommended Solder Pad Design

Recommended Soldering Pad Design

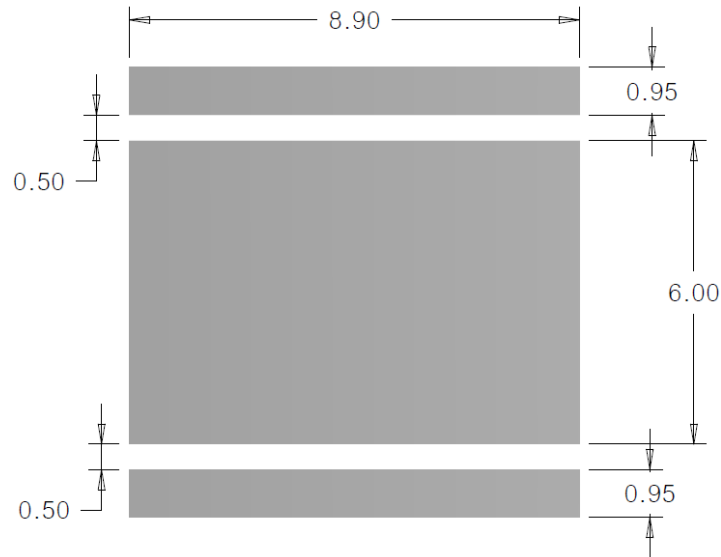

Recommended Stencil Pattern Design (Marked Area is Opening)

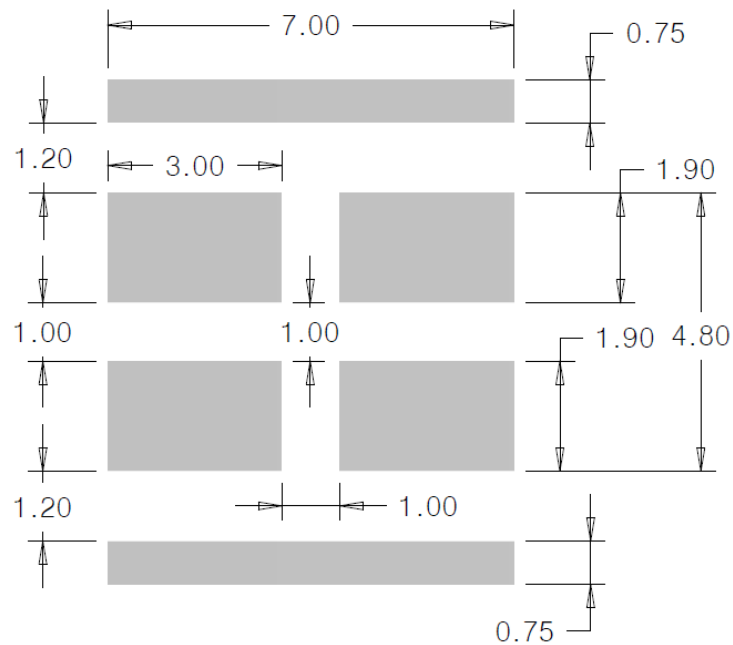

Notes :

1. Drawing is not to scale
2. All dimensions are in millimeter

Relative Spectral Power Distribution, T_j=25°C

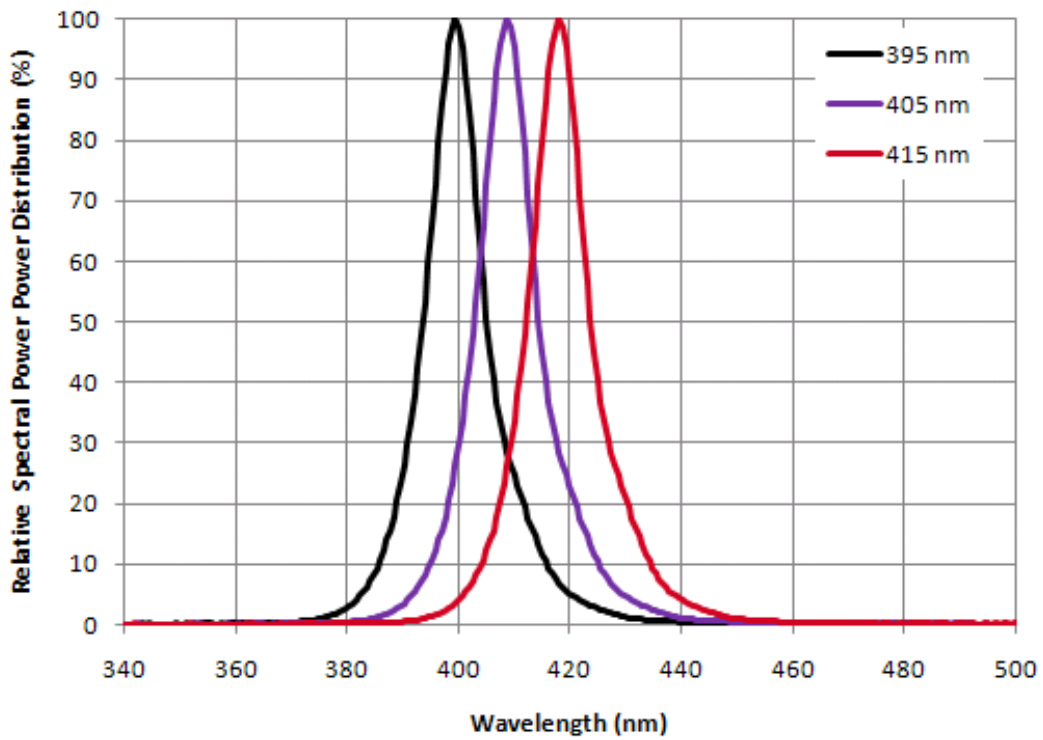

Typical Spatial Radiation Pattern

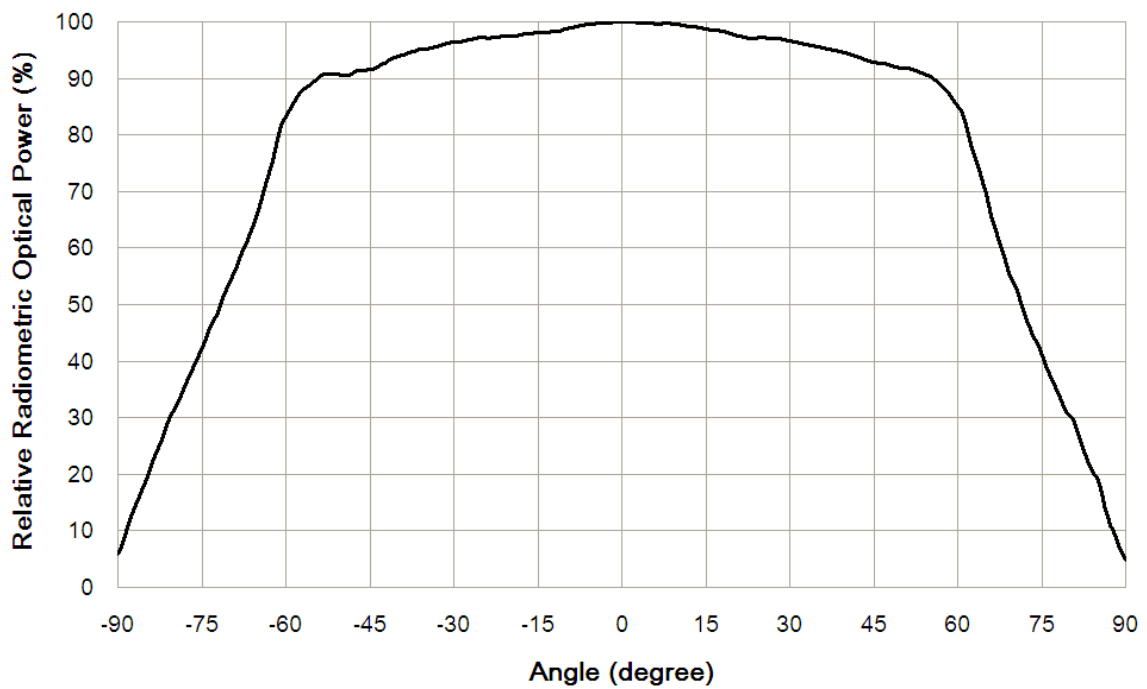

Typical Forward L-I Characteristics, $T_j=25^\circ\text{C}$

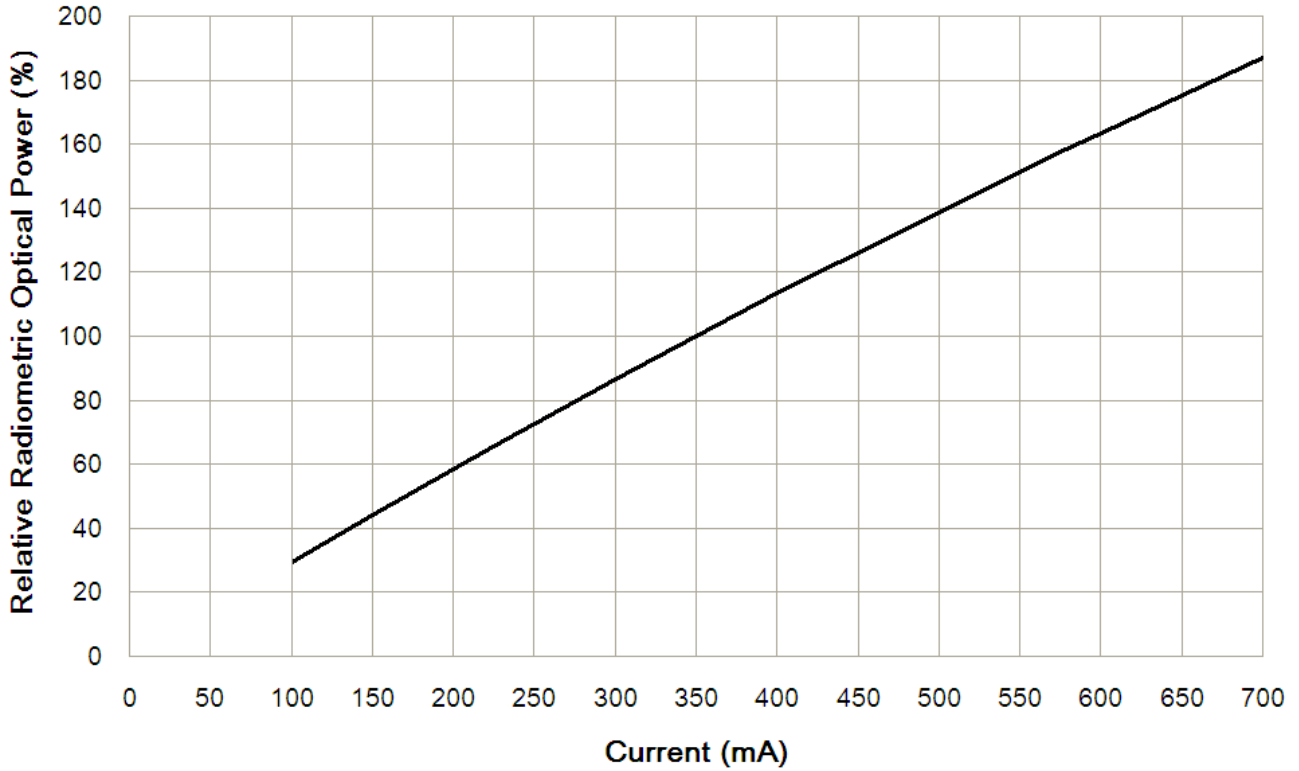

Typical Forward I-V Characteristics, $T_j=25^\circ\text{C}$

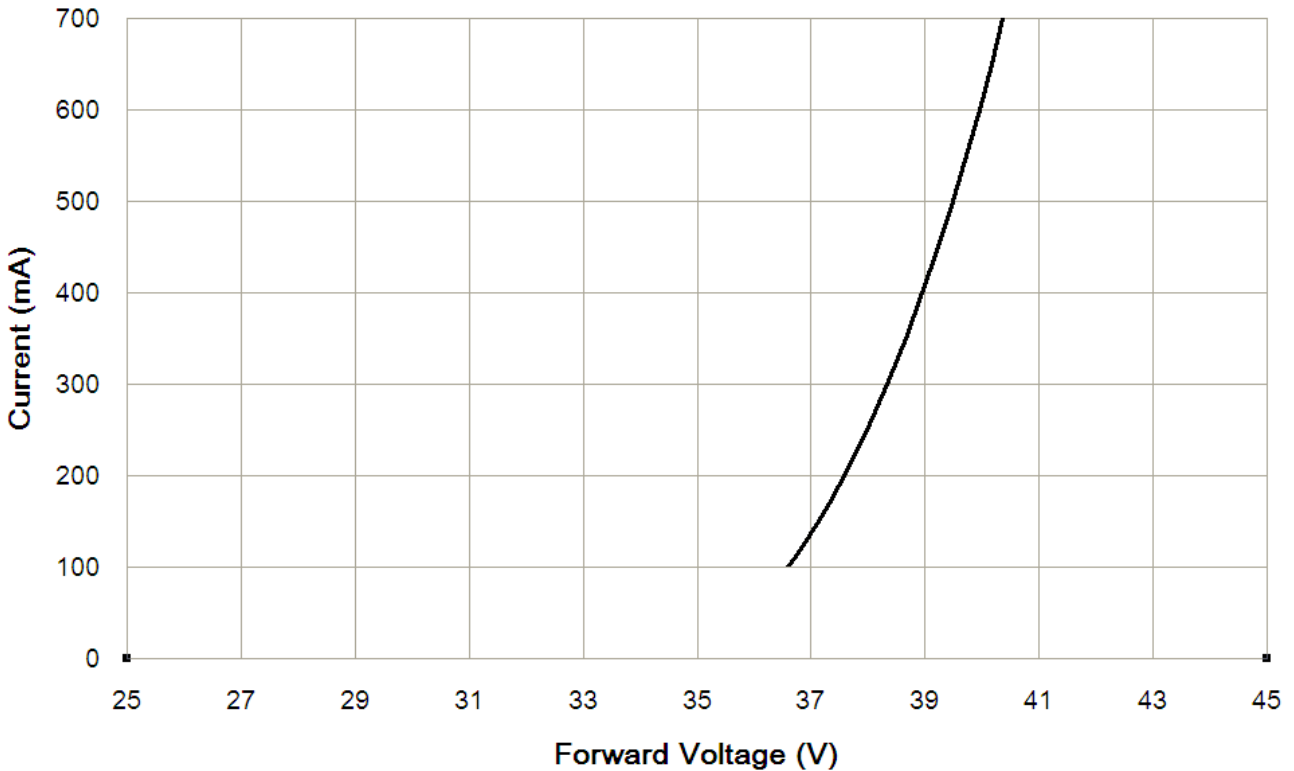

Recommended Soldering Profile

The LEDs can be soldered using the parameters listed below. As a general guideline, the users are suggested to follow the recommended soldering profile provided by the manufacturer of the solder paste. Although the recommended soldering conditions are specified in the list, reflow soldering at the lowest possible temperature is advised for the LEDs.

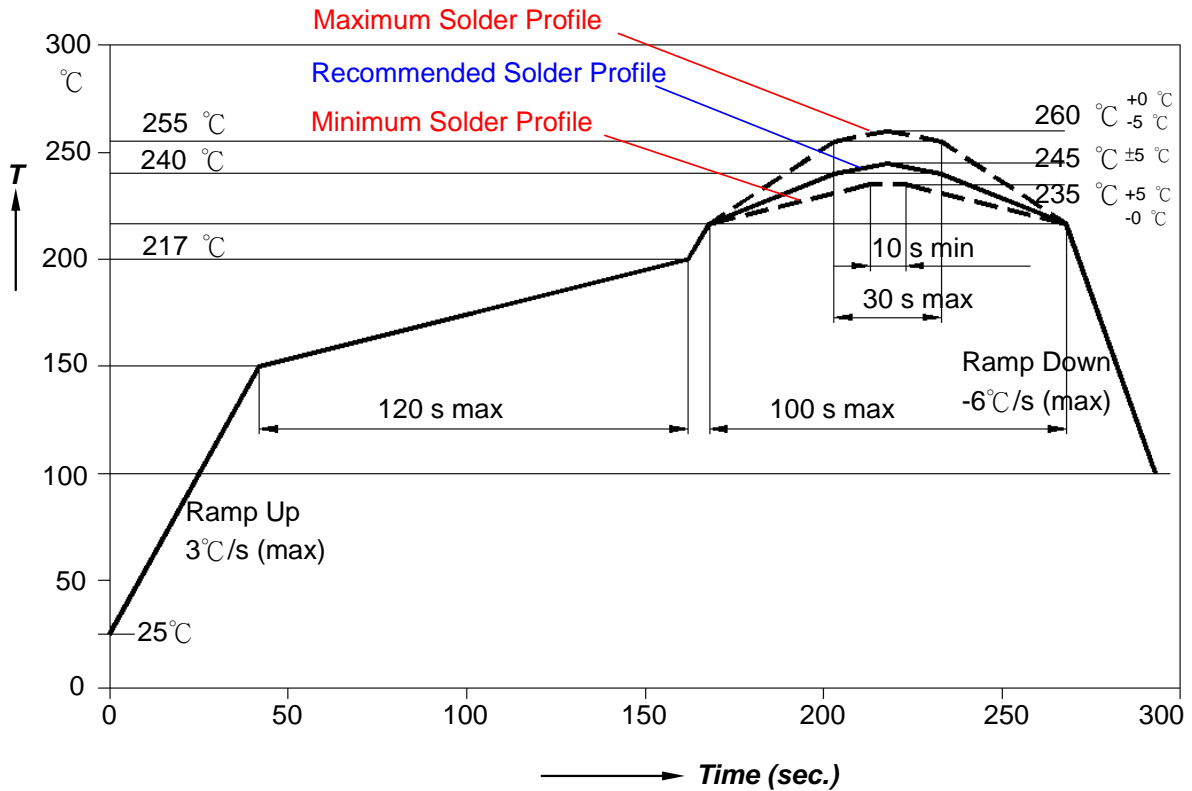

Profile Feature	Sn-Pb Eutectic Assembly	Pb-Free Assembly
Average Ramp-up Rate (Ts _{max} to Tp)	3°C /second max.	3°C /second max.
Preheat		
- Temperature Min(Ts _{min})	100°C	150°C
- Temperature Max(Ts _{max})	150°C	200°C
- Time(ts _{min} to ts _{max})	60-120 seconds	60-180 seconds
Time maintained above:		
- Temperature(T _L)	183°C	217°C
- Time(t _L)	60-150 seconds	60-150 seconds
Peak/classification Temperature(Tp)	215°C	260°C
Time within 5°C of actual Peak Temperature(tp)	10-30 seconds	20-40 seconds
Ramp-Down Rate	6°C /second max.	6°C /second max.
Time 25°C to Peak Temperature	6 minutes max.	8 minutes max.

Thermal Design

Thermal design of the end product is important. The thermal resistance between the junction and the solder point ($R_{\theta_{j-p}}$) and the end product should be designed to minimize the thermal resistance from the solder point to ambient in order to optimize the emitter life and optical characteristics. The maximum operation current is determined by the plot of Allowable Forward Current vs. Ambient Temperature.

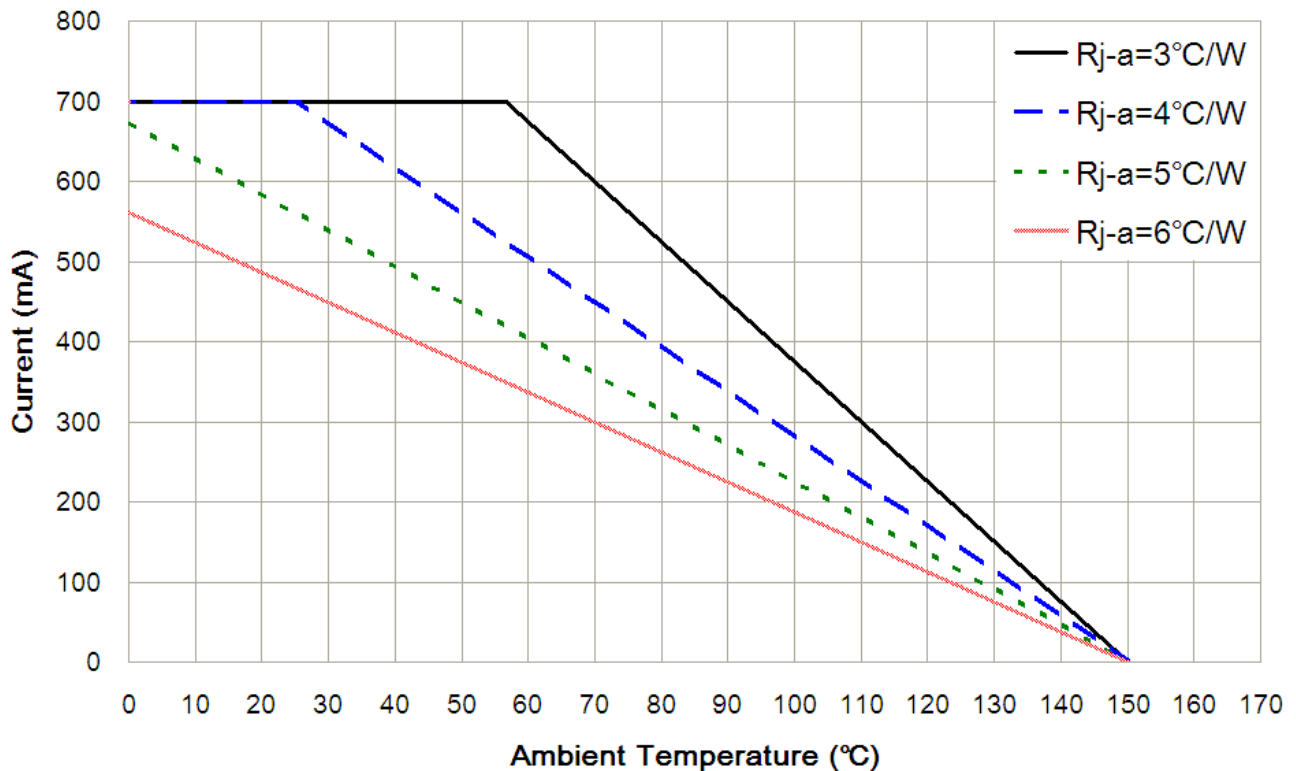

The junction temperature can be correlated to the thermal resistance between the junction and ambient (R_{ja}) by the following equation.

$$T_j = T_a + R_{ja} * W$$

T_j : LED junction temperature

T_a : Ambient temperature

R_{ja} : Thermal resistance between the junction and ambient

W : Input power ($I_F * V_F$)

Package Information

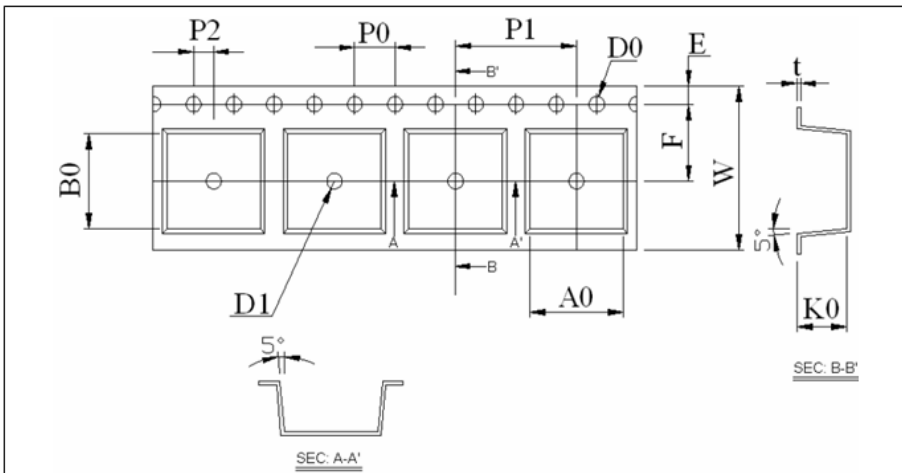

Item	Specification	Tol.(+/-)
W	16.00	±0.30
E	1.75	±0.10
F	7.50	±0.10
D0	1.50	+0.10, -0
D1	1.50	+0.25, -0
P0	4.00	±0.10
P1	12.00	±0.10
P2	2.00	±0.10
P0X10	40.00	±0.20

Item	Specification	Tol.(+/-)
t	0.40	±0.05
A0	9.40	±0.10
B0	9.40	±0.10
K0	5.05	±0.10

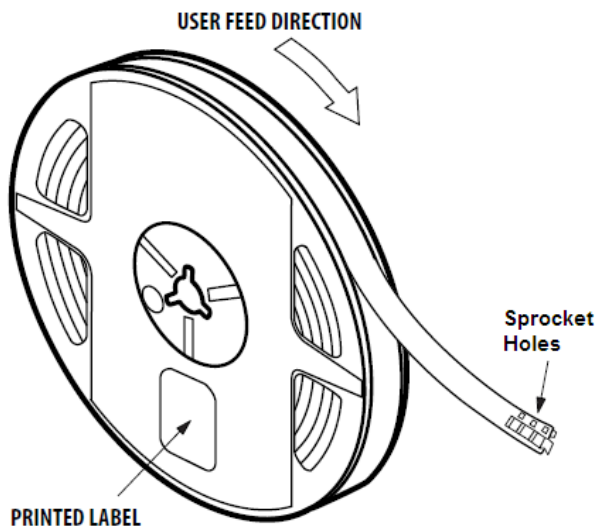
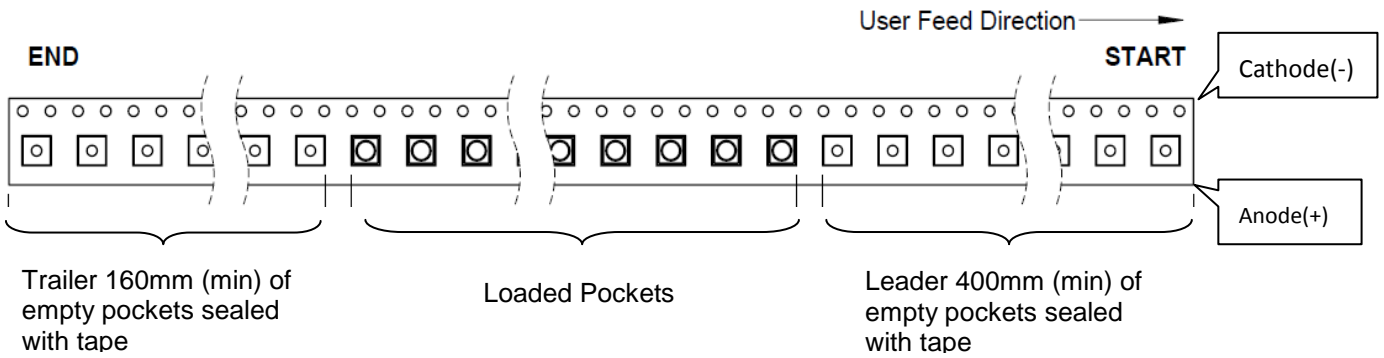

Note:

All dimensions are in millimeter.

About Us

TSLC Corporation is devoted to developing high-density, and multi-size emitters with powerful output to satisfy the needs of every customer.

TSLC Corporation is the leader in LED solutions. Unlimited design flexibility for interior and exterior spaces with high-end lighting effect; energy-efficient for UV curing to improve the quality of medical care; horticulture solutions create a better environment for everyone; high-intensity rotatable lightings for the entertainment industry, TSLC is always there for your lighting needs.

For further company or product information, please visit us at www.tslc.com.tw or please contact sales@tslc.com.tw.



www.tslc.com.tw

ASIA PACIFIC

1F, No. 11, Ke Jung Rd.

Chu-Nan Site

Hsinchu Science Park

Chu-Nan 350, Miao-Li City

Taiwan, ROC

Tel: +886-37-587098

Fax: +886-37-587099

sales@tslc.com.tw

